

Note: - File No. 1600, is here applied to the Construction Plans for Babcock Blvd. and Related Projects. P.W.A. No. Docket No. 9616. The Drawing Descriptions and Consecutive Sheet Nos. for the Entire Project are as follows:-

DRAWING DESCRIPTIONS	CONSECUTIVE SHEET NOS.	REVISIONS
Approximate Quantities	2	
BABCOCK BLVD. & CONNECTIONS - Sta. 1+00 to 2+00 (Plan & Profile)	3	
1+00 to 1+50	4	
1+50 to 2+00	5	
2+00 to 2+50	6	
2+50 to 3+00	7	
3+00 to 3+50	8	
3+50 to 4+00	9	
4+00 to 4+50	10	
4+50 to 5+00	11	
5+00 to 5+50	12	
5+50 to 6+00	13	
6+00 to 6+50	14	
6+50 to 7+00	15	
7+00 to 7+50	16	
7+50 to 8+00	17	
8+00 to 8+50	18	
8+50 to 9+00	19	
9+00 to 9+50	20	
9+50 to 10+00	21	
10+00 to 10+50	22	
10+50 to 11+00	23	
11+00 to 11+50	24	
11+50 to 12+00	25	
12+00 to 12+50	26	
12+50 to 13+00	27	
13+00 to 13+50	28	
13+50 to 14+00	29	
14+00 to 14+50	30	
14+50 to 15+00	31	
15+00 to 15+50	32	
15+50 to 16+00	33	
16+00 to 16+50	34	
16+50 to 17+00	35	
17+00 to 17+50	36	
17+50 to 18+00	37	
18+00 to 18+50	38	
18+50 to 19+00	39	
19+00 to 19+50	40	
19+50 to 20+00	41	
20+00 to 20+50	42	
20+50 to 21+00	43	
21+00 to 21+50	44	
21+50 to 22+00	45	
22+00 to 22+50	46	
22+50 to 23+00	47	
23+00 to 23+50	48	
23+50 to 24+00	49	
24+00 to 24+50	50	
24+50 to 25+00	51	
25+00 to 25+50	52	
25+50 to 26+00	53	
26+00 to 26+50	54	
26+50 to 27+00	55	
27+00 to 27+50	56	
27+50 to 28+00	57	
28+00 to 28+50	58	
28+50 to 29+00	59	
29+00 to 29+50	60	
29+50 to 30+00	61	
30+00 to 30+50	62	
30+50 to 31+00	63	
31+00 to 31+50	64	
31+50 to 32+00	65	
32+00 to 32+50	66	
32+50 to 33+00	67	
33+00 to 33+50	68	
33+50 to 34+00	69	
34+00 to 34+50	70	

SHEET INDEX

SCALE: 1" = 400 FEET

- NOTE -
 THE PLAN FOR THE GENERAL CONTRACT FOR BARCOCK BOULEVARD, LAKE, DAM, AND LAKESHORE DRIVE IS PLAN NO. 1600, SHEETS NOS. 1 TO 63 INCLUSIVE, AND STANDARD PLANS NOS. 1024, 1024-A, 1043, 1044, 1045, 1046, 1047, 1048, 1049, 1050 & 1051.
 THE GENERAL CONSTRUCTION PLAN FOR THE BOAT HOUSE IS PLAN NO. 1600, SHEETS NOS. 1 AND 64 TO 70 INCLUSIVE.
 THE PLUMBING CONSTRUCTION PLAN FOR THE BOAT HOUSE IS PLAN NO. 1600, SHEETS NOS. 1 AND 64 TO 70 INCLUSIVE.
 THE ELECTRICAL CONSTRUCTION PLAN FOR THE BOAT HOUSE IS PLAN NO. 1600, SHEETS NOS. 1 AND 64 TO 70 INCLUSIVE.

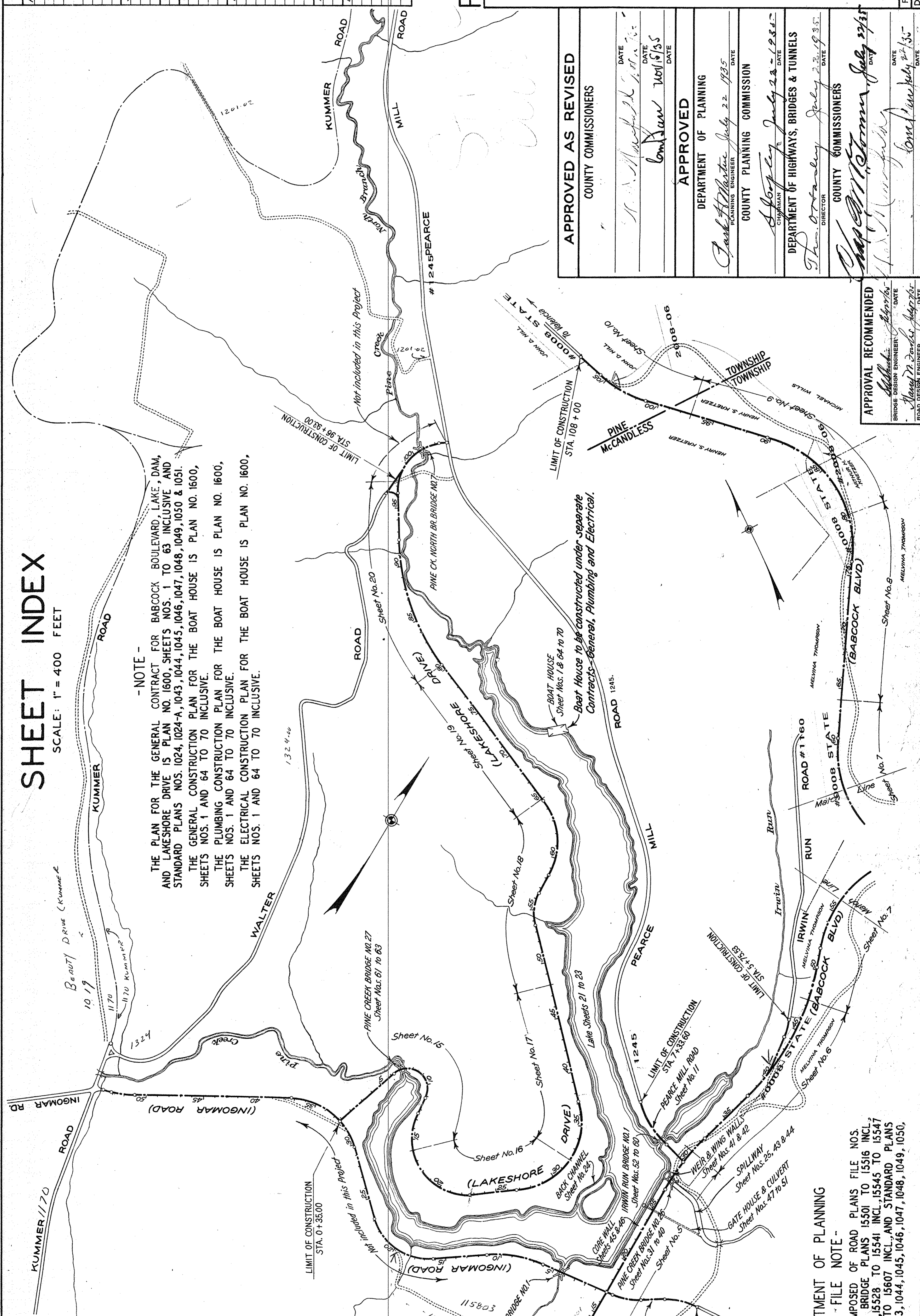

DRAWING DESCRIPTIONS	CONSECUTIVE SHEET NOS.	REVISIONS
PINE CK. BRIDGE NO. 26 (Spillway Bridge)	37	
General Plan	37	
Elevations & Sections	32	
Plan of Rigid Frame	33	
Rigid Frame Foundations	34	
Rigid Frame Details	35	
Wing Walls - Elevations & Sections	36	
Wing Walls & Ties - Details	37	
Elevations of Stone Facing	38	
Details of Stone Facing	39	
Details of Wing Walls & Ties	40	
General Plan of Spillway Channel	41	
Elevations of Spillway Channel	42	
Plan & Sections of Spillway	43	
General Plan	44	
Sections & Details	45	
General Plan	46	
Culvert & Details	47	
Plan & Elevations of Stone Facing	48	
Miscellaneous Details	49	
General Plan	50	
Railing Details	51	
General Plan	52	
Details of Arch	53	
Details of Downstream Wing Walls	54	
Details of Upstream Wing Walls	55	
Details of Parapets	56	
Details of Tie Walls	57	
Downstream Elevations of Stone Facing	58	
Upstream Elevations of Stone Facing	59	
Details of Stone Facing	60	
General Plan	61	
Foundations & Wing Walls	62	
Location of Stone Facing	63	
Location of Stone Facing	64	
Floor Elevations & Details	65	
Front Elevations & Details	66	
Rear Elevations & Details	67	
Stair Details	68	
Tower Details	69	
Lower Details	70	

P.W.A. - PA. DOCKET NO. 9616



CONSTRUCTION PLAN

OF

BABCOCK BOULEVARD & CONNECTIONS, LAKE & DAM, AND LAKESHORE DRIVE

IN

MCCANDLESS & PINE TOWNSHIPS

APPROVED AS REVISED	COUNTY COMMISSIONERS
DATE: 10/15/35	DATE: 10/15/35
APPROVED	DEPARTMENT OF PLANNING
DATE: 10/15/35	DATE: 10/15/35
APPROVED	COUNTY PLANNING COMMISSION
DATE: 10/15/35	DATE: 10/15/35
APPROVED	DEPARTMENT OF HIGHWAYS, BRIDGES & TUNNELS
DATE: 10/15/35	DATE: 10/15/35
APPROVED	COUNTY COMMISSIONERS
DATE: 10/15/35	DATE: 10/15/35

APPROVAL RECOMMENDED
 BRIDGE DESIGN ENGINEER
 ROAD DESIGN ENGINEER

DEPARTMENT OF PLANNING
 FILE NOTE -
 PLAN NO. 1600 IS COMPOSED OF ROAD PLANS FILE NOS. 1601, 1603 & 1604 AND BRIDGE PLANS 15501 TO 15516 INCL. 15519 TO 15522 INCL. 15528 TO 15541 INCL. 15545 TO 15547 INCL. 15562 & 15601 TO 15607 INCL. AND STANDARD PLANS NOS. 1024, 1024-A, 1043, 1044, 1045, 1046, 1047, 1048, 1049, 1050, & 1051.

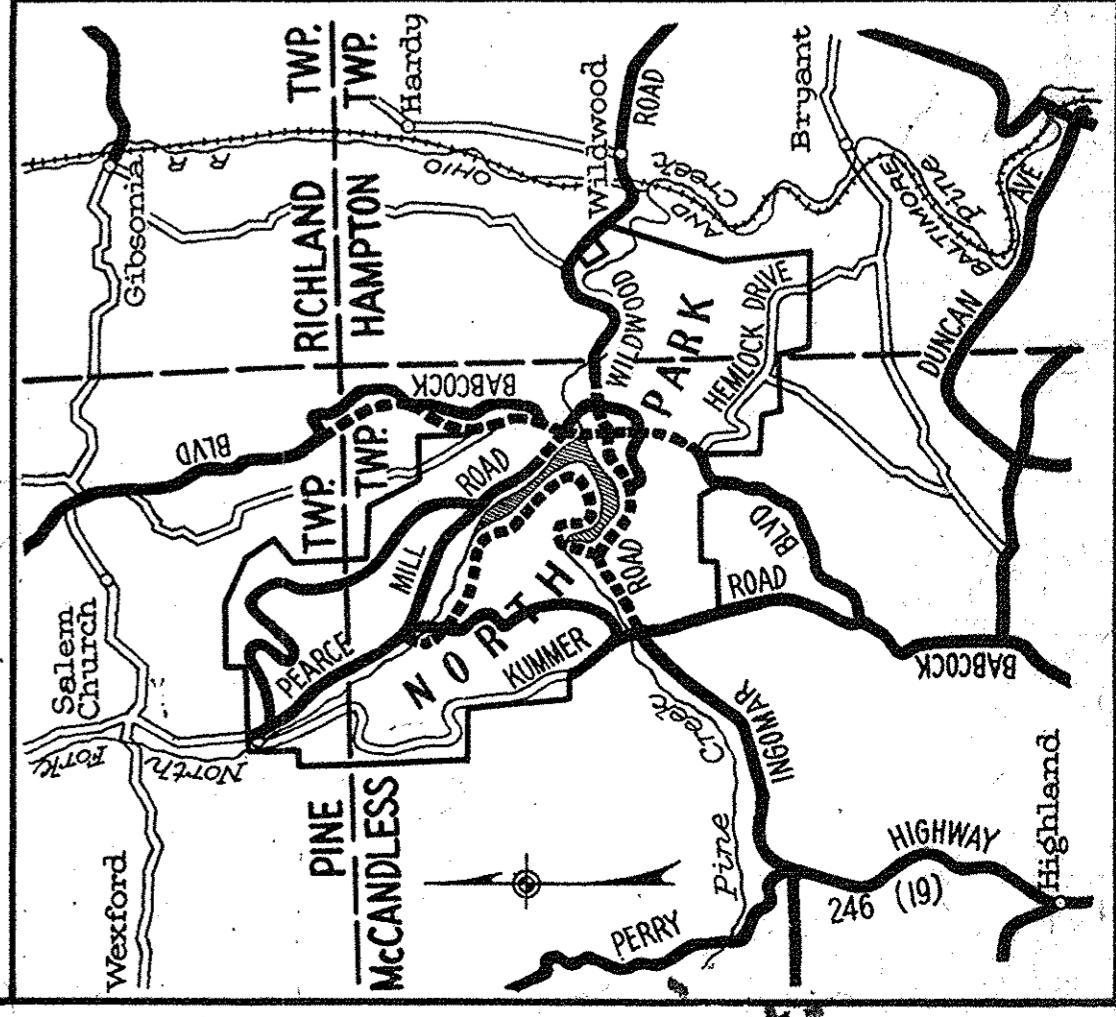

Case 1
 5/11/23
 ALSO IN
 STATE
 FILE 0008
 11/25/35
 11/22